

ΑΡΙΘΚΤΗΜΑΤΟΣ "ΠΟΛΟΧΩΡΙ"

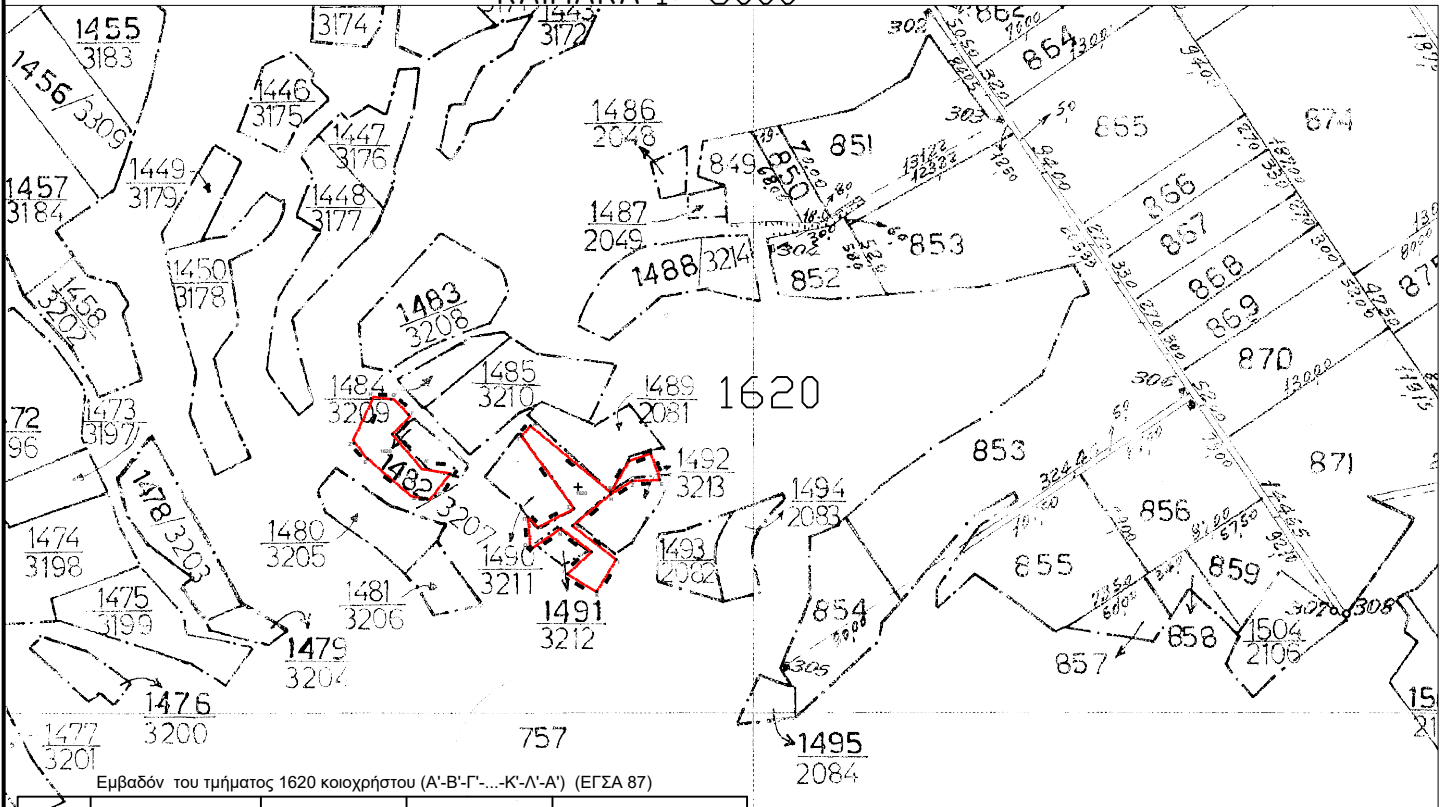

ΕΓΣΑ 87

ΣΥΜΠΛ/ΚΗ ΔΙΑΝΟΜΗ 1992-97
ΚΛΙΜΑΚΑ 1: 5000



Α/Α	ΑΡ. ΣΗΜΕΙΩΝ	X	Y	ΜΗΚΟΣ ΠΛΕΥΡΑΣ
1	Α'	504408.35	4517062.23	4.93
2	Β'	504405.38	4517058.30	17.08
3	Γ'	504396.03	4517044.01	12.74
4	Δ'	504383.33	4517045.07	39.80
5	Ε'	504351.05	4517068.36	13.69
6	Ζ'	504342.05	4517078.67	31.65
7	Η'	504353.16	4517108.31	13.51
8	Θ'	504366.66	4517107.78	15.45
9	Ι'	504378.32	4517097.65	16.89
10	Κ'	504367.38	4517084.78	30.45
11	Λ'	504389.14	4517063.48	19.25
12	Α'	504408.35	4517062.23	

Εμβαδό = 1802.22 μ2

Εμβαδόν του τμήματος 1620 κοιοχρήστου (Α-Β-Γ-...-Σ-Τ-Α) (ΕΓΣΑ 87)

Α/Α	ΑΡ. ΣΗΜΕΙΩΝ	X	Y	ΜΗΚΟΣ ΠΛΕΥΡΑΣ
1	Α	504468.49	4517090.30	68.65
2	Β	504521.35	4517046.46	24.02
3	Γ	504533.55	4517067.15	15.30
4	Δ	504548.01	4517072.16	18.49
5	Ε	504554.03	4517054.68	18.46
6	Ζ	504535.58	4517054.04	16.92
7	Η	504521.24	4517045.06	32.58
8	Θ	504496.14	4517024.29	36.51
9	Ι	504525.05	4517001.99	25.03
10	Κ	504512.00	4516980.64	22.58
11	Λ	504492.66	4516992.30	29.96
12	Μ	504508.92	4517007.07	25.68
13	Ν	504488.50	4517022.65	23.00
14	Ξ	504469.60	4517009.55	1.91
15	Ο	504468.22	4517010.87	19.16
16	Π	504466.81	4517029.98	9.26
17	Ρ	504473.24	4517023.31	27.00
18	Σ	504497.24	4517035.68	59.23
19	Τ	504462.35	4517083.54	9.13
20	Α	504468.49	4517090.30	

Εμβαδό = 2545.09 μ2